

EVENT
HIRE

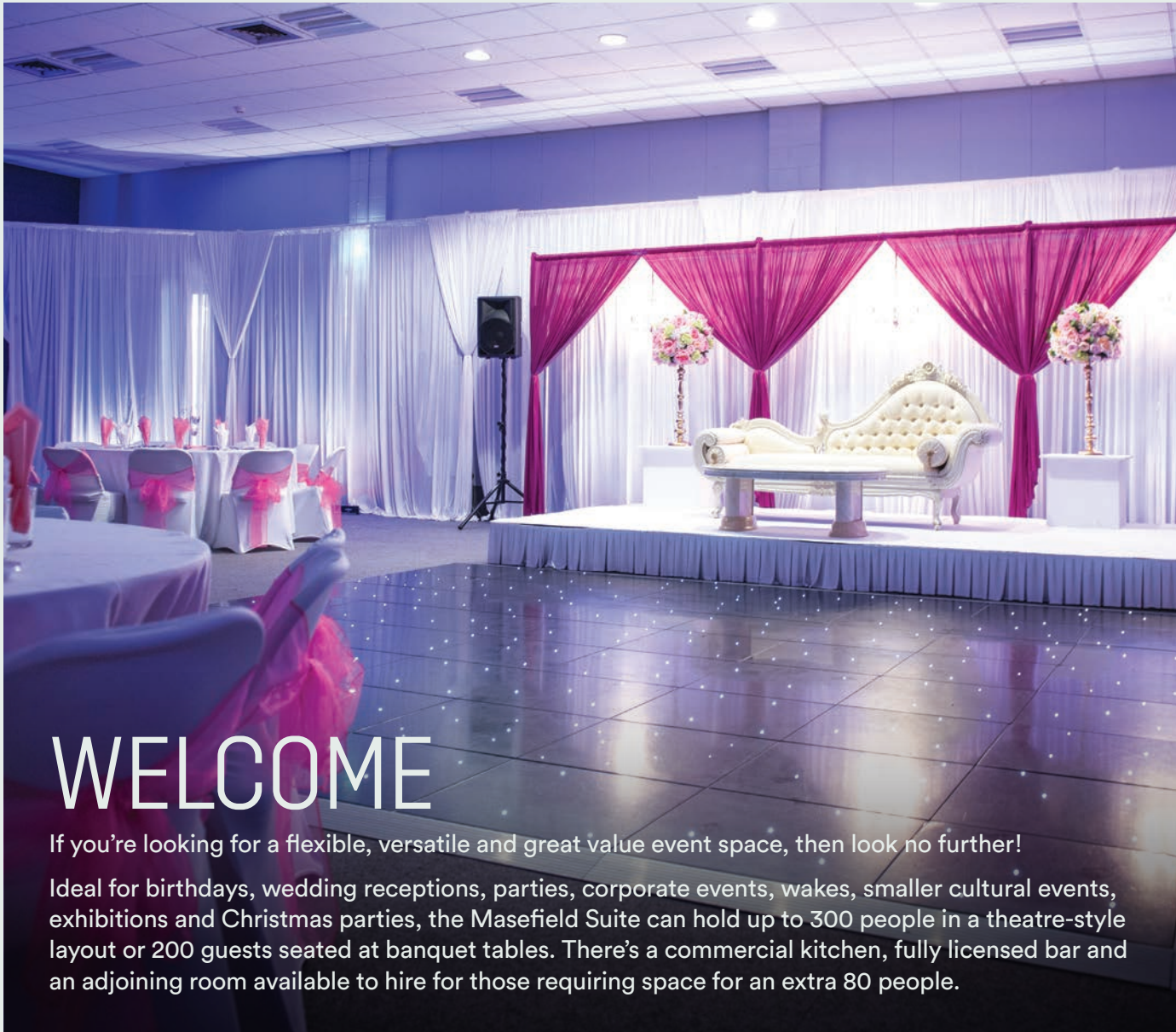

MASEFIELD SUITE

AN IDEAL LOCATION FOR A WIDE RANGE OF EVENTS



WELCOME

If you're looking for a flexible, versatile and great value event space, then look no further!

Ideal for birthdays, wedding receptions, parties, corporate events, wakes, smaller cultural events, exhibitions and Christmas parties, the Masefield Suite can hold up to 300 people in a theatre-style layout or 200 guests seated at banquet tables. There's a commercial kitchen, fully licensed bar and an adjoining room available to hire for those requiring space for an extra 80 people.



MASEFIELD SUITE

Capacities

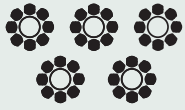

Banquet style: 200



Cabaret style: 100



Theatre style: 300



Standing: 300

Dimensions

Length - 18.6m

Width - 14m

Height - 4m

Power

Numerous 13 amp sockets

3 Phase - 63 amp / 240-415 voltage

Staging

Length - 3.7m

Width - 2.4m

Height - 0.3m

Tables

Round (seats 10) x 25 Trestle x 10

Chairs

Folding x 300

Banquet x 30

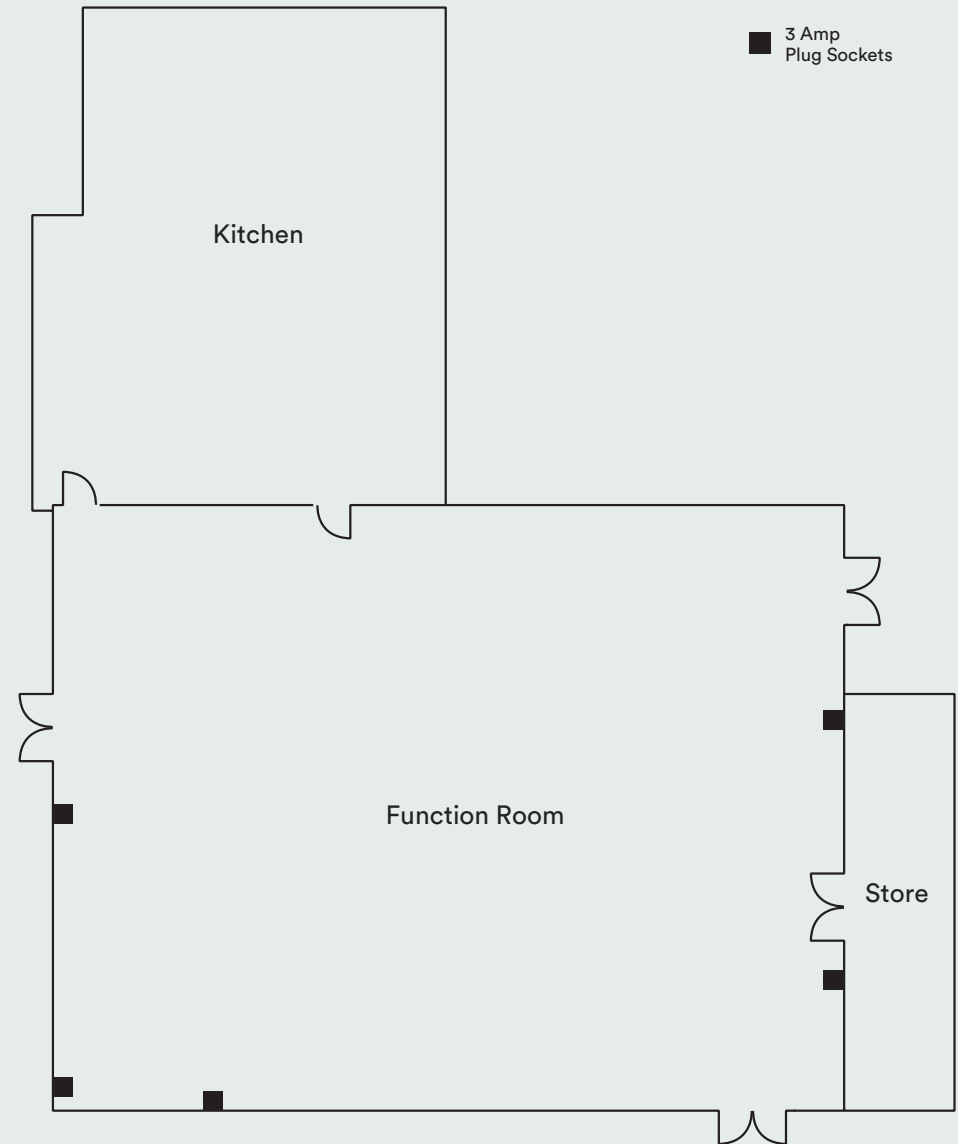



CATERING

Whether it's an essential cup of morning coffee and a selection of pastries at a business meeting, or a buffet and cash bar at a private party, full catering services can be provided tailored to your needs.

Alternatively, as we understand the importance of making your event entirely bespoke, we also offer the opportunity for you to provide your own food and drinks if you so desire. Please contact the team for more information.



AVAILABILITY

The Masfield Suite is available to hire seven days a week from:

06:30-23:00 Monday to Thursday

06:30-00:00 Friday to Sunday

An extension to closing times may be available on request.



LOCATION

The Masefield Suite is within Harrow Leisure Centre, which is a short distance from the M25, M40, M1 and A1. Harrow and Wealdstone train station is only a five minute walk with regular trains from London Euston taking just 12 minutes.

Harrow Leisure Centre
Christchurch Avenue, Harrow, HA3 5BD

CAR PARKING

The facility has 450 car parking spaces.

