

EVENT
HIRE



BYRON HALL

AN IDEAL LOCATION FOR A WIDE RANGE OF EVENTS



WELCOME

If you're looking for a flexible, versatile and great value event space for up to 1,800 guests, then look no further!

Ideal for cultural events, wedding receptions, examinations, exhibitions, sporting tournaments and community gatherings, the Byron Hall is one of the largest pillar-less function spaces in West London. The unique blank canvas venue has a dedicated entrance, commercial kitchen and toilets, as well as a fully licensed bar, ticketing station and cloakroom.



BYRON HALL

Capacities

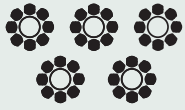

Banquet style: 800



Cabaret style: 400



Theatre style: 1700



Standing: 1800

Dimensions

Length - 44m

Width - 40m

Height - 3.6m (beams start)

Power

Numerous 13 amp sockets

3 Phase - 63 amp / 380-415 voltage

Staging

Length - 9.7m

Width - 7.3m

Height - 0.9m

Tables

Round (seats 10) x 75 Trestle x 10

Chairs

Folding x 600

Banquet x 60

- 3 Amp Plug Sockets
- ▲ Sound Limiter and Trip Bored

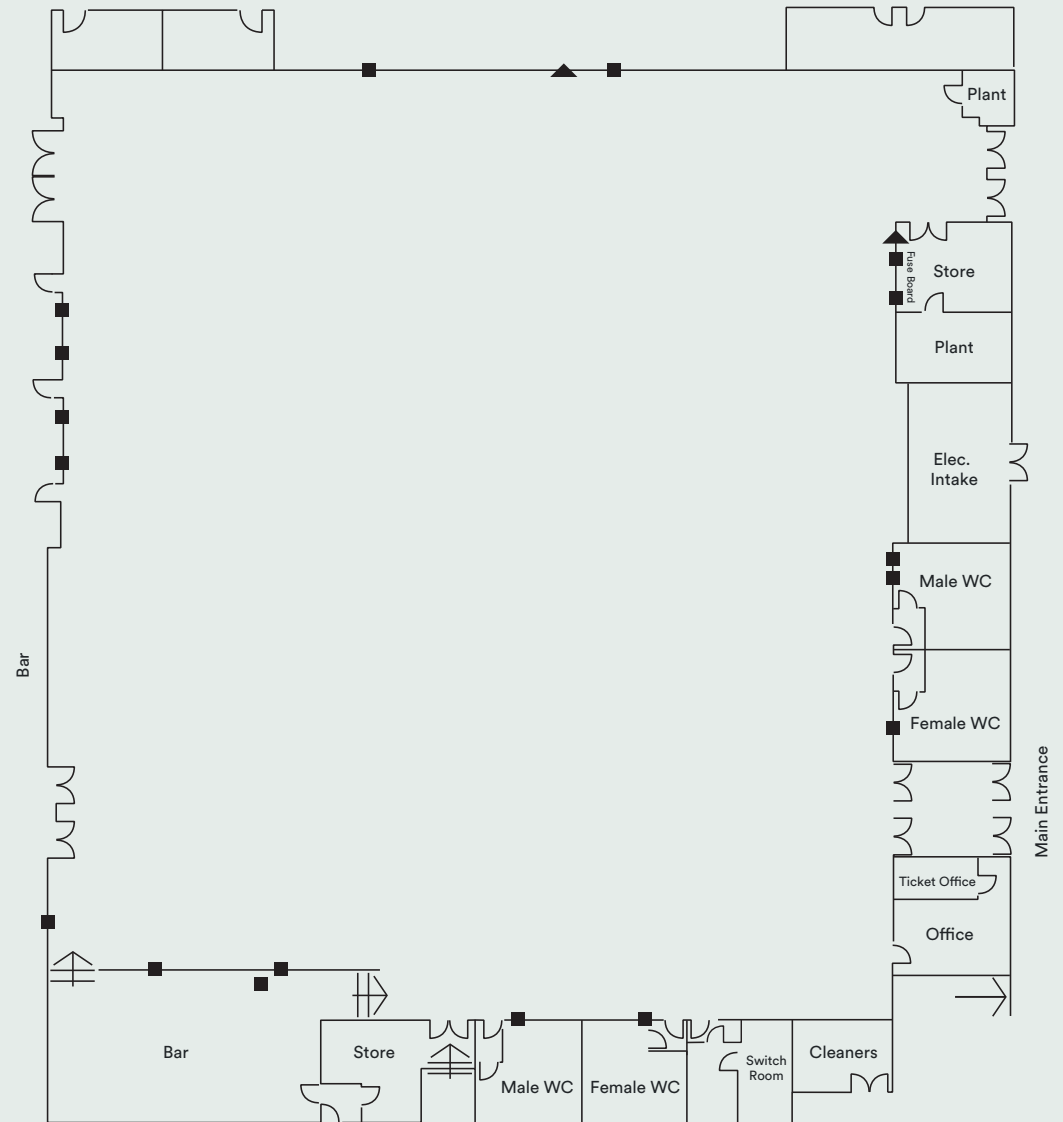



CATERING

Full catering services can be provided tailored to your needs and budget. Alternatively, as we understand the importance of making your event entirely bespoke, we also offer the opportunity for you to provide your own food and drinks if you so desire. Please contact the team for more information.

AVAILABILITY

The Byron Hall is available to hire seven days a week from:

06:30-23:00 Monday to Thursday

06:30-00:00 Friday to Sunday

An extension to closing times may be available on request.

ACCESS

There is a loading area with direct access to the Byron Hall.





LOCATION

The Byron Hall is within Harrow Leisure Centre, which is a short distance from the M25, M40, M1 and A1. Harrow and Wealdstone train station is only a five minute walk with regular trains from London Euston taking just 12 minutes.

Harrow Leisure Centre
Christchurch Avenue, Harrow, HA3 5BD

CAR PARKING

The facility has 450 car parking spaces.

