



PORCHESTER  
HALL



# WEDDINGS

EVERYONEEVENTS



City of Westminster

[www.everyoneevents.com](http://www.everyoneevents.com)



# Welcome to Porchester Hall

Porchester Hall's Grade II listed classic art deco design and understated elegance make it a sought-after venue for weddings of all sorts.

The grand entrance to the Hall is ideal for reception drinks and leads guests up the elegant staircase with its ornamental bronze and wrought banisters, striking marble walls and crystal chandelier. From the stairway, guests are led through to the Main Hall, which is the very essence of grandeur and opulence.

## History

Porchester Hall was opened in 1929 alongside the Turkish Baths and Library on Porchester Road. It provided the Borough of Paddington with a dignified Public Hall intended primarily for use by the residents in the area but its beauty and convenience appealed to a wider circle. The foundation stone was laid by the Mayor Leonard Snell, JP, and this can be found at main entrance to the hall.



# Main Hall

The grand entrance is ideal for reception drinks and leads guests up the elegant staircase with its ornamental bronze and wrought iron banisters, striking marble walls and crystal chandelier. From the stairway, guests are led through to the Main Hall, which is the very essence of grandeur and opulence. The Hall walls are handsomely panelled in English oak and walnut, with luxurious rich crimson velvet curtains. Fascinating figurines and motifs support the main beams, while ten magnificent crystal chandeliers, adorned in gold leaf effect, hang from the superbly engraved ceiling.

The lavish Main Hall can accommodate up to 600 guests for a standing reception; 450 in theatre style for a ceremony and 450 for a seated dinner.

## Small Hall, Duchess of York Suite and Blue Room

There are a number of other charming rooms within the venue - the Small Hall and the Duchess of York Suite - while the Blue Room is ideal for a bridal area or backstage space for the band. The Small Hall is a delightful venue in its own right, ideal for smaller weddings of up to 50 guests.



Main Hall



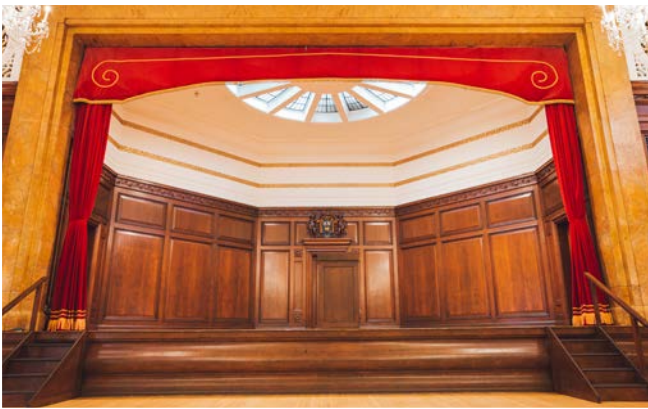

# Main Hall Floor Plans

**Banquet** 450 (with a dance floor)

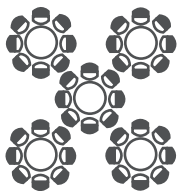

**Theatre Style** 450



**Reception** 600 (standing)

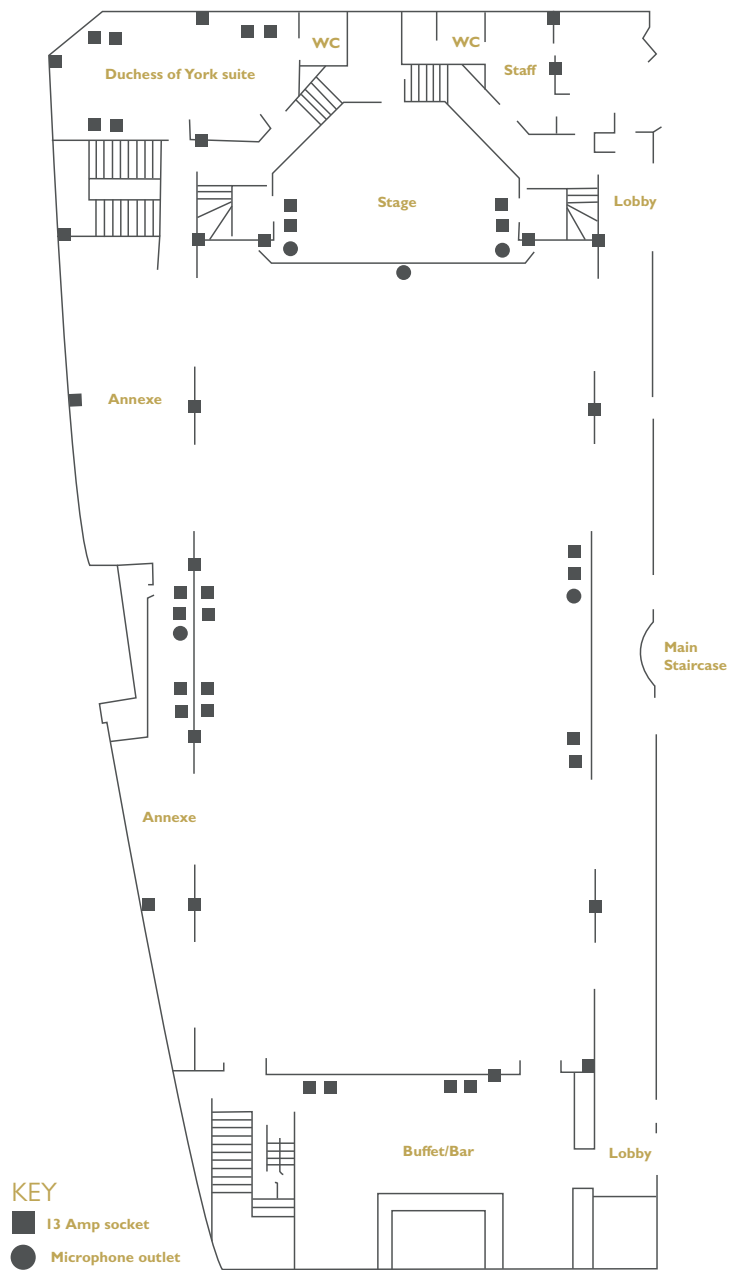



# Food

Delivering a high quality and professional service is key to the continued success of Porchester Hall.

As such we work with a carefully selected group of caterers to provide you with a wonderful selection of menu choices to suit all cultures, tastes and budgets

# Drinks

Drinks packages or fully stocked cash bars are available through your caterer.

Alternatively you can supply your own alcoholic drinks for a corkage fee, which includes use of our oak bar. Your chosen caterer will provide glasses, service, chilling and recycling of bottles/ cardboard and the re-boxing of any leftovers for your collection for a service charge, which varies per caterer.



# Dimensions and Specifications

## Main Hall

### Dimensions

Length - 30.3m  
Width - 15.15m  
Height - 7.5m  
Height to chandeliers - 4.0m  
Distance between chandeliers - 6.5m

### Stage

Width - 9.7m  
Depth - 5.75m  
Stage from floor - 0.88m  
Height - 5.2m  
(Wood panel - 3.4m, Plaster - 1.8m)  
Length - 3.99m + 3.88m 3.99m panels

### Power

Numerous 13 amp sockets in main hall and stage  
100 amp 3 phase power  
125 amp 3 phase power available on balcony

### Tables

Round (seats 10) x 45  
Diameter - 5ft/Drop - 2.4ft  
Trestle x 10/Dimensions - 6ft x 2.5ft/Drop - 2.4ft

### Chairs

Banquet x 450  
Height - 90cm/Width - 43cm/Depth - 41cm

### Alcove

4.75m x 10.5m

### Back Alleyway

Gate width - 3.6m

### Lift

Interior - 2.0m x 1.4m  
Door - 0.8m x 2.0m

### Platform

Length - 2.77m  
Height - 0.31m  
Width - 1.52m

### Dividers

Red x 4  
Height - 1.50m/Length - 1.22m  
Dark x 4  
Height - 1.80m/Length - 1.23m

## Small Hall

### Dimensions

Length - 11.5m  
Width - 8.5m  
Height - 4.37m  
Height from floor to top of wood panels - 2.6m







# Location

Located in Bayswater, Paddington; Porchester Hall is within walking distance of Royal Oak, Bayswater and Queensway Tube stations which are on both the Hammersmith & City and Central Lines.

Porchester Hall, Porchester Road, London W2 5HS

# Car parking

There are two NCP car parks within 100 yards of the hall on Queensway and Porchester Terrace North.

There is ample street parking locally after 18:30 Monday to Friday; 13:30 on Saturday and all day Sunday.

Our customers are entitled to a 20% discount with Q-park located on Queensway, 26 Queensway, London, W2 4QJ

# Access

There is a loading area with lift access to both the hall and kitchen with restricted use between 08:00 and 00:00 only. There is no on-site parking for any hirer or contractor.

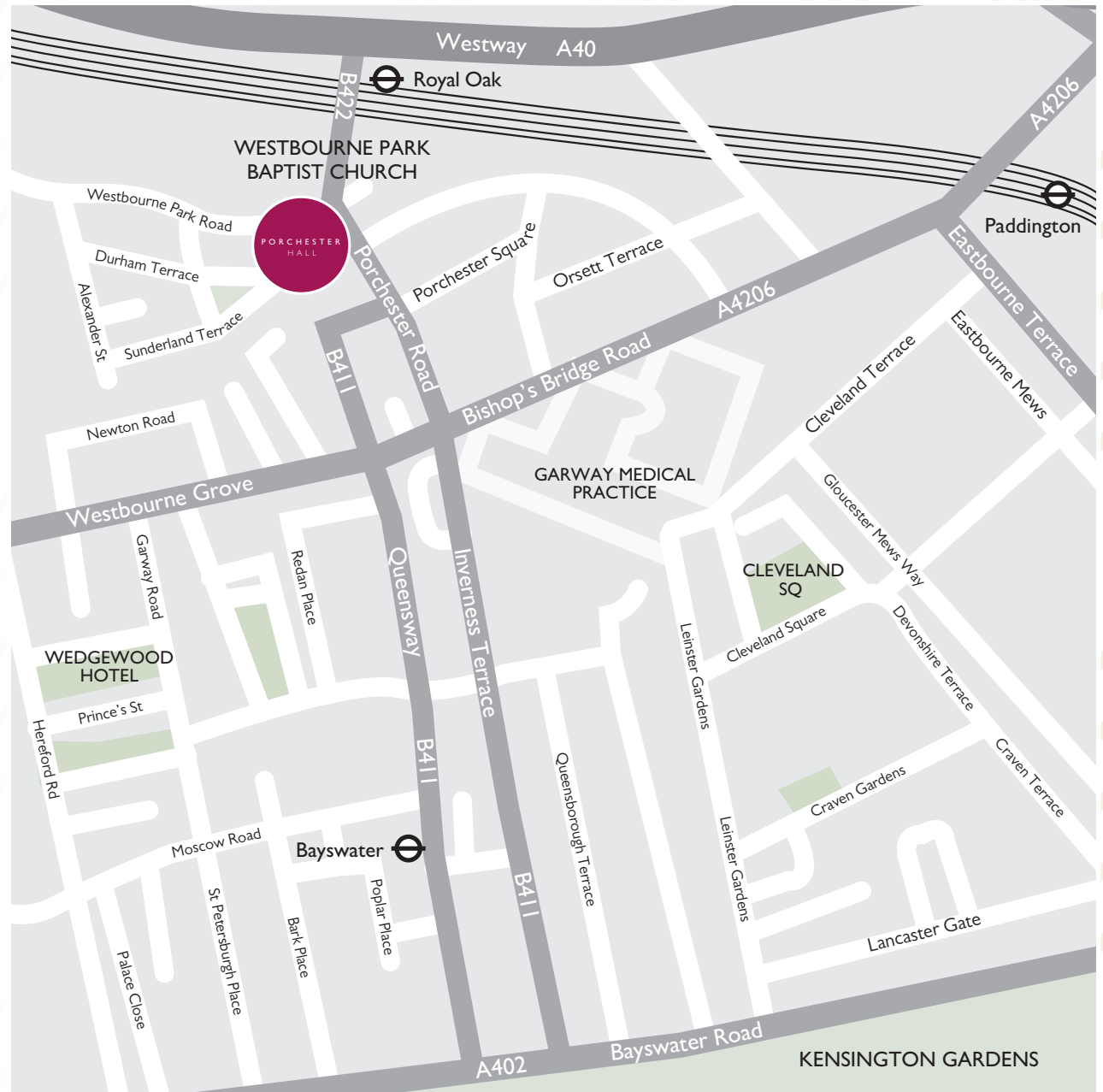

# Our happy couples

“We would like to say a huge thanks for all your help. We had the best day and everyone commented on how lovely the food and venue was.”

Deepansh and Hardip

“What a wonderful day. Thanks to everyone who made our day even more special.”

Jauntita and Kiran

“On behalf of the couple and ourselves we just wanted to thank you for your services and the success of the day. We are so grateful to have worked with you and look forward to many more endeavours in the future.” Kemi and Enny

## Availability

The hall is available seven days a week;

Monday-Thursday: 11:00-23:30

Friday and Saturday: 08:00-00:30

Sunday: 14:00-23:00

An extension to closing times may be available on request.

## Find us at

Porchester Hall, Porchester Road, London W2 5HS

Tel: 03330 05 0415

Email: [porchesterevents@everyoneactive.com](mailto:porchesterevents@everyoneactive.com)

[www.everyoneevents.com](http://www.everyoneevents.com)





